

ELECTRONIC CIGARETTE
PCC (LED)
USER MANUAL

TECHNOLOGY OF ELECTRONIC CIGARETTE

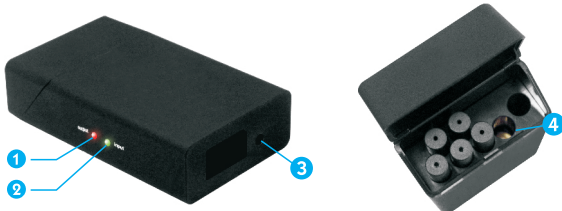

CHARGING THE PCC

- Attach the USB end of the charging cable into the wall charger.
- Attach the other end of the charging cable into the input port of the portable charging case (PCC)
- Plug the charging unit into the wall. The input LED will turn red indicating that the charging is starting, and it will keep being red during the charging period.
- The input LED will turn green when the PCC get fully charged, and will keep being green until you stop the charging.
- Recommended charging time: 2.5-3 hours.

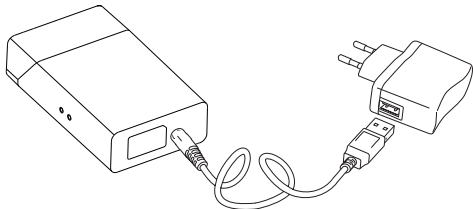

CHARGING THE BATTERY WITH PCC

- Simply screw (for PCCA, PCC B) or gently push (for PCC D) the battery into the corresponding charging hole in the PCC until it sits firmly into place. Do not use any force while doing this.

ELECTRONIC CIGARETTE

An electronic cigarette, also known as the smokeless electronic cigarette or a personal vaporizer, can be used as an alternative to traditional cigarettes, cigars, or pipes by providing the physical sensation of smoking or "vaporizing". It is comprised of a cartridge, an atomizer and a rechargeable lithium ion battery (three-piece model):



Or comprised of a lithium ion battery and a cartomizer (two-piece model):



The electronic cigarette provides with efficacies similar to those of the ordinary cigarette. It can refresh the smokers and satisfy their smoking addiction, making them happy and relaxed so as to relieve the suffering of quitting smoking. The E-Cig does not actually "burn" anything, which is the major cause of the 4000 carcinogens that are found in a burning tobacco cigarette.

WORKING PRINCIPLE

When a user takes a "puff" from the E-Cig, the pressure sensor triggers the microprocessor and turns on the atomizer and the LED which are powered by the battery. The atomizer uses the E-Liquid, or Smoke Juice, mixture from the cartridge, producing vapor.

ASSEMBLY

Simply push the Cartridge into the Atomizer until you hear a small click.
Notice: To remove the Cartridge, simply pull on it until it comes out. Never twist the cartridge when it is inside the Atomizer or you may damage the Atomizer.



- The output LED will turn red once a solid connection is made. At the same time, the battery LED will blink for 5 times and then the charging procedure starts.
- The output LED will keep being red before the battery is fully charged.
- The output LED will turn green when the charging is over, and will keep being green for 3 minutes, and then go off, meanwhile, the PCC will automatically shut down the charging circuit to save power.

Remarks: There are intelligent microchips inside both the battery and PCC, providing an automatically cut-off function and overcharge protection.

Notice: The output LED will keep blinking red to notice you that the PCC needs recharging when its voltage is under 3.3V. You can still charge the battery with PCC during this while. When the voltage goes down under 3V, the PCC will stop working and run into a safe mode to protect itself.

BATTERY LED BLINKING NOTICE

- When the battery LED blinked for:**
- 5 times, it indicates that the battery is well connected to the charger and the charging is ready.
 - 7 times, it alarms that you have kept using the E-cigarette for over 12 seconds, which means that the E-cigarette has been overused.
 - 15 times, it indicates that there is a short circuit inside the atomizer.
 - 30 times, it indicates that the battery is in need of recharging.



Screwing the (Atomizer+Cartridge) onto the corresponding part on the Battery. Do not use force when doing this and do not over tighten the Atomizer.

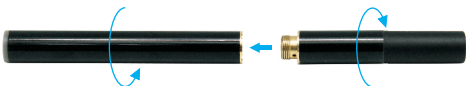

SUITABLE/UNSUITABLE USERS

E-Cigs/ Personal Vaporizers are intended for adults that are of the legal smoking age. You should consult your physician before use if you suffer from high blood pressure, heart disease, pregnancy or suffer from allergic reactions to VG (vegetable glycerin), PG (propylene glycol) or Nicotine based products.

ELECTRONIC CIGARETTE PCC

APCC (Portable Charging Case) is the best way to both carry and charge your electronic cigarettes on the go. It is a small box which resembles a regular tobacco cigarette box but it has and does much more. The PCC is equipped with a rechargeable battery, USB port (or other input jack for power), output port (this is where the electronic cigarette battery screws in) and lets you charge your electronic cigarettes on the go.

- 1 Output LED indicator
- 2 Input LED indicator
- 3 Input port
- 4 Output port

MAINTENACE

- Drip 2-3 drops of E-liquid into the Atomizer before smoking for the first time to aid the Atomizer break-in process.
- Be sure to keep your battery threads, atomizer threads and charger threads clean. This can be done using a dry tissue. Cleaning your threads will provide a good connection ensuring a proper charge and good vapor production. If your connections are not clean, the battery might not charge or vapor production might be low.
- At night when your atomizer is not in use turn it upside down sticking up on a paper towel to allow the old liquid to drain out over night, but not penetrating into the battery.



PRECAUTIONS

- Only Genuine accessories should be used, and the proper operation procedures must be followed to prevent malfunction and damage to the product. We do not accept warranty claims if you use other operation procedures other than the ones stipulated herewith.
- Keep your E-cigarette and PCC from other articles such as keys and change, which could collide with the device and cause cosmetic or functional damage to your E-cigarette and PCC. Warranty claims for cosmetics will not be accepted.
- In the case that a problem should arise with your E-cigarette or PCC, please contact us and do not try to dismantle them yourself. Opening the Battery compartments or PCC inside cabin will result in complete malfunction of them and void the warranty.
- Keep away from "HIGH" temperature extremes and humidity.
- Keep the whole kit out of children's reach, and avoid improper operation.

尺寸：90*115mm
材质：105克铜版纸 / 哑膜 / 折 / 翻叠
四色印刷